

DISCLAIMER
 The purchaser of these plans agrees and understands that the designer is not responsible for the actual construction or adaptation of these plans to local code conditions, building codes or modifications. It is the responsibility of the purchaser to verify all dimensions and to consult a local engineer with questions of structural interest.

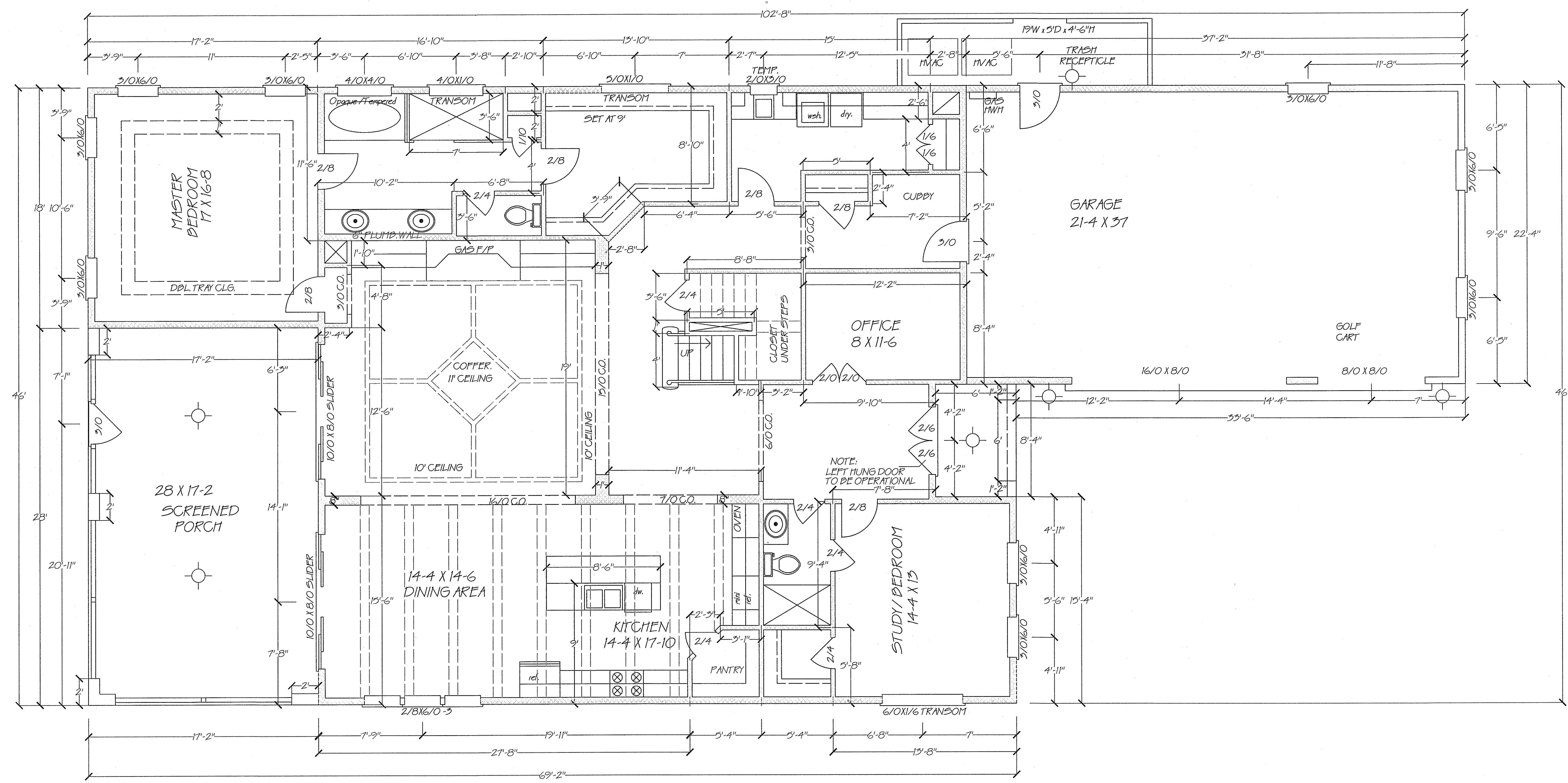

FLOOR PLAN
 2517 SQ. FT. HEATED (FIRST)
 830 SQ. FT. GARAGE
 481 SQ. FT. SCR. PORCH
 50 SQ. FT. PORCH
 1/4 INCH SCALE

drawn for: **BRANDON ARNETTE**
 LOT 381, The Bluffs, Horry County, SC
 SCALE AS LABELED

Custom Home Plans, LLC
 Pam Bellamy Hobeika
 843-997-6558 (c) 843-557-2580
 P.O. BOX 2760 MURRELLS INLET, SC 29576

DISCLAIMER
 The purchaser of these plans agrees and understands that the designer is not responsible in any way for the actual construction or adaptation of these plans to local conditions, building codes or modifications. It is the responsibility of the purchaser to consult with local officials to ensure all local requirements are met and to consult with a professional engineer or architect as needed.

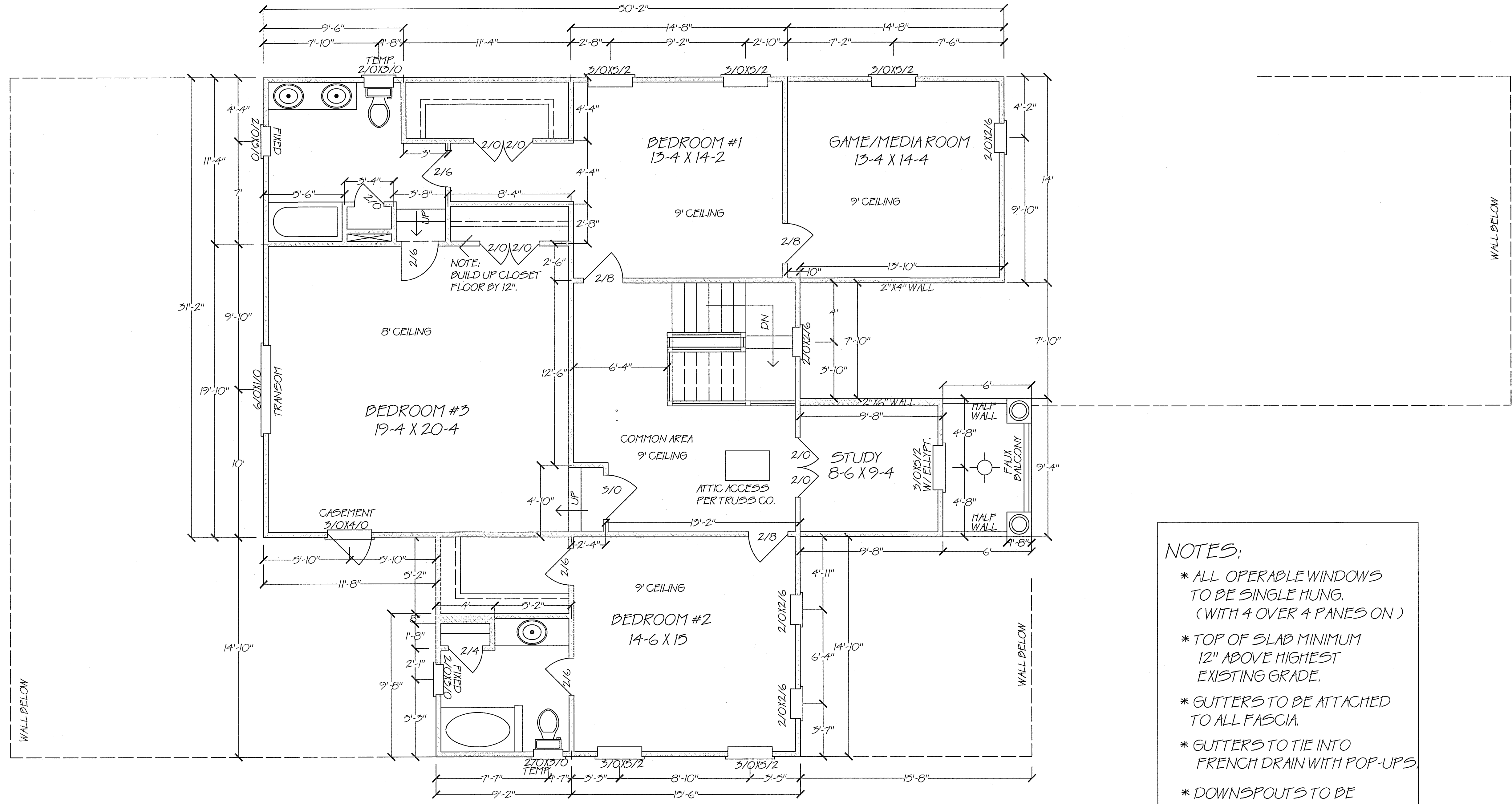

FLOOR PLAN
 1708 SQ. FT. HEATED (SECOND)
 1/4 INCH SCALE

- NOTES:**
- * ALL OPERABLE WINDOWS TO BE SINGLE HUNG. (WITH 4 OVER 4 PANES ON)
 - * TOP OF SLAB MINIMUM 12" ABOVE HIGHEST EXISTING GRADE.
 - * GUTTERS TO BE ATTACHED TO ALL FASCIA.
 - * GUTTERS TO TIE INTO FRENCH DRAIN WITH POP-UPS.
 - * DOWNSPOUTS TO BE LOCATED PER SITE PLAN.
 - * CONTRACTOR TO VERIFY ALL DIMENSIONS AND LOCAL BUILDING CODE COMPLIANCE.
 - * SEE SAMPLE BOARD FOR ALL COLORS, BROCHURES AND MANUFACTURER SPECS.
- ⊙ OUTDOOR LIGHTING

drawn for: **BRANDON ARNETTE**
 LOT 381, The Bluffs, Horry County, SC
 SCALE AS LABELED

Custom Home Plans, LLC
 Pam Bellamy Hobeika
 843-997-6558 (c) 843-557-2580
 P.O. BOX 2760 MURRELLS INLET, SC 29576

HC Public #9751
 DATE: 7/26/2022
 REV: 8/12/2022
 REV: 9/13/2022
 REV: 9/26/2022
 PRINTING #3

REV: 10/11/2022